

INFORMATION BULLETIN 1
2019 ECA CANOE SLALOM EUROPEAN CHAMPIONSHIPS
PAU
30TH MAY TO 2ND JUNE

EUROPEAN
CANOE ASSOCIATION

FFCK
Canoe-Kayak et Sports de Pagaie

**CHAMPIONNAT
D'EUROPE ECA
DE CANOË-KAYAK SLALOM**

STADE D'EAUX VIVES
PARC AQUASPORTS
du 29 MAI au 2 JUIN 2019
PAU

#PAUCANOE
WWW.PAUCANOE.COM

Logos for sponsors: ZONLIER, EDF, FEARNS, PAU BEARN PYRENEES, Nouvelle-Aquitaine, PYRENEES MONTAGNES, and the French flag.





Contents

Introduction.....	3
Words of presidents	3
Key dates	4
The organising committee.....	4
Useful contacts.....	4
General information	5
How to access Pau ?	5
Accommodation	6
Ticketing information	6
Sport information	7
The whitewater stadium	7
Other training facilities.....	7
Do you need visas ?	8
Special regulations in France.....	8
Canoe slalom safety rules for equipment	8
European Championships period	9
Entries.....	11
Appendixes	13
Participation form	13
Travel details	14
Visa form	15



INTRODUCTION

From 30th May to 2nd June, the whitewater stadium of Pau-Pyrénées, new name is Parc Aquasports, will welcome the 2019 ECA Canoe Slalom European Championships.

It will be an opportunity for the general public to (re)discover our spectacular discipline and the various athletes, only 2 years after the 2017 ICF World Championships which was a total and great success.

The city of Pau and its metropolitan area has a big sporting culture and has already proved their capacity to host events at the highest level : Tour de France (cycling), CCI 5* (riding), Pelota world championships (2010), ... and for canoe slalom numerous ICF World Cups and one ICF World Championships.

Feel free to join us to share together strong emotions and nice sensations through this exciting adventure !

The Organising Committee

WORDS OF PRESIDENTS

For many years, the French Canoe Federation gained a lot of competences in hosting international competitions of great quality. The history in Pau began in 2009 with the ICF Canoe Slalom World Cup at the new inaugurated whitewater stadium of Pau-Pyrénées. Then, it never ends to confirm the trust the international governing bodies of canoeing put in the Pau Organising Committee and in the French Canoe Federation.

It is with the same enthusiasm and the same passion that French Canoe Federation and Pau Béarn Pyrénées community of towns will work together in order to lead a new exciting project.

We hope to see you soon in Pau !

Jean ZOUNGRANA, French Canoe Federation President (photo)

François BAYROU, Mayor of Pau (photo)

KEY DATES

20 th January 2019	Opening of numerical entries
20 th January 2019	Opening of online accreditations
15 th April 2019	Closing of numerical entries
30 th April 2019	Deadline for visa requirement
20 th May 2019	Closing of nominal entries
27 th May 2019	Opening of competition venue
From 26 th to 29 th May 2019	Official trainings Free trainings Official equipment control
29 th May 2019	Team leaders meeting ITOs meeting Opening ceremony
30 th May 2019	Competition day 1
31 st May 2019	Competition day 2
1 st June 2019	Competition day 3
2 nd June 2019	Competition day 4 Closing ceremony Closing of the venue

THE ORGANISING COMMITTEE

Presidents

Jean ZOUNGRANA – French Canoe Federation President

François BAYROU – Mayor of Pau and President of community of towns

USEFUL CONTACTS

Website : www.paucanoe.com

Facebook : www.facebook.com/paucanoe/ / Instagram : www.instagram.com/paucanoe

Sport Information : events@ffck.org

General Information : contact@paucanoe.com

GENERAL INFORMATION

HOW TO ACCESS PAU ?

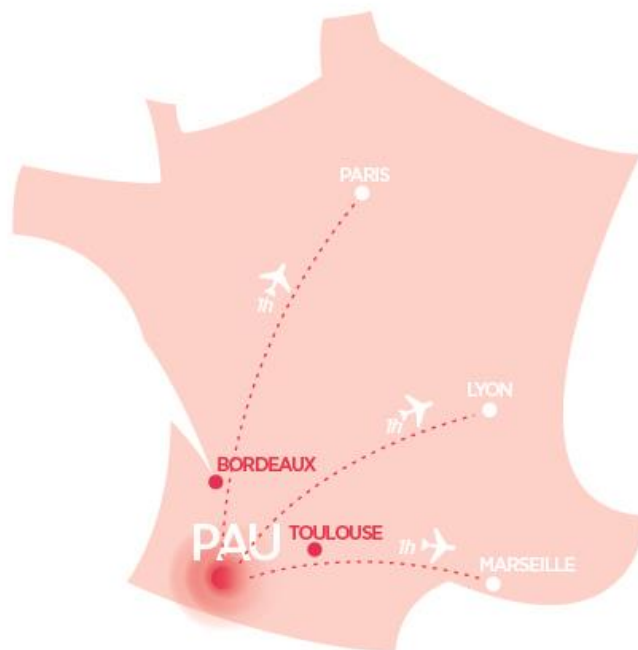

PAU PYRENEES AIRPORT

35 MINUTES from the White Water Stadium
PARIS (ORLY & ROISSY-CDG) 9 daily flights
LYON 3 daily flights



MOTORWAYS

Exit at 10 min from the White Water Stadium
A65 BORDEAUX - PAU > 2 H
A64 BIARRITZ - PAU > 1 H
A64 TOULOUSE - PAU > 2 H



10 Min WALKING from the White Water Stadium
DIRECT TGV from PARIS (5H)
DIRECT ACCESS from BORDEAUX & TOULOUSE



ACCOMMODATION

All information : <https://fr.calameo.com/read/00005548229f94f917d17>

TICKETING INFORMATION

The organising committee will implement a ticketing policy. Prices are coming soon. You will receive information as soon as they are published. Keep an eye on social networks.

SPORT INFORMATION

THE WHITEWATER STADIUM

The European Championships will take place on the brand artificial stadium of Pau-Pyrénées, built around the river "Gave de Pau".

Technical attributes

- Length : 280 meters
- Width : 15 meters
- Drop : 5 meters with an average slope of 2%
- Water flow during the Final World Cup : 14 m³
- 50-meter boat lift system
- 200-meter initiation basin, warm-up and cool-down areas linked to the "Gave"

If you want to use the course before the competition for training camps, you can book training slots directly at the whitewater stadium. During these periods, you will paddle on your own responsibility and costs.

Parc Aquasports (Whitewater stadium of Pau Pyrénées), Avenue Léon Heïd, 64320 BIZANOS

+33 5 59 40 85 44

OTHER TRAINING FACILITIES

Stadium Pont d'Espagne – Jurançon / Avenue Corps Franc Pommies 64110 JURANCON

Stadium Pont des Grottes – Saint-Pé de Bigorre / Impasse de la Pradette 65270 ST PE DE BIGORRE

Whitewater Stadium – Orthez / Route de Biron 64300 ORTHEZ

DO YOU NEED VISAS ?

France is a state-member of the European Union. The French Embassy in your country will provide you with all detailed information about visas. You will find details in the website on French Foreign Affairs Ministry (<http://www.diplomatie.gouv.fr/en/>).

Please inform in advance but no later than 30th April 2019 the Organising Committee together with the visa form whether your team needs entry visas to France.

You will find in appendix a visa form to fulfil.

SPECIAL REGULATIONS IN FRANCE

Evin laws (N. 91-32 January 10th 1991)

This law forbids advertising for all alcoholic beverages (any level of alcohol including beer) and tobacco inside sports arenas (canoe slalom stadium is a sport arena). No advertising on tracksuits, boats, paddles, ...

Protection of athlete health law (N. 99-223 March 23rd 1999)

Specific doping regulations on French territory.

CANOE SLALOM SAFETY RULES FOR EQUIPMENT

Each competitor must wear a safety helmet with a strap fastened under the chin and a buoyancy jacket (article 19.2, ICF Canoe Slalom rules).

A buoyancy jacket must comply with the current industry standard that is ISO 12402-5 (level 50) or any national standard that meets the same requirements and be ICF registered by 1st January in order to be authorized for use in Olympic Games and/or ICF level 1,2 & 3 competition that year (article 19.2.1, ICF Canoe Slalom rules).

The safety helmet must comply with EN 1385 and be ICF registered by 1st January in order to be authorized for use in Olympic Games and/or ICF level 1,2 & 3 competition that year (article 19.2.2, ICF Canoe Slalom rules).

EUROPEAN CHAMPIONSHIPS PERIOD

Competition venue map



Access to Competition site on 25th and 26th May

Due to Grand Prix Auto of Pau (<https://www.grandprixdepau.fr/en/pau-historic-grand-prix/practical-information/>), specific road signs will be put in place to guide you. All city centre will be closed. Arrival to the competition site will only be possible through Bizanos.

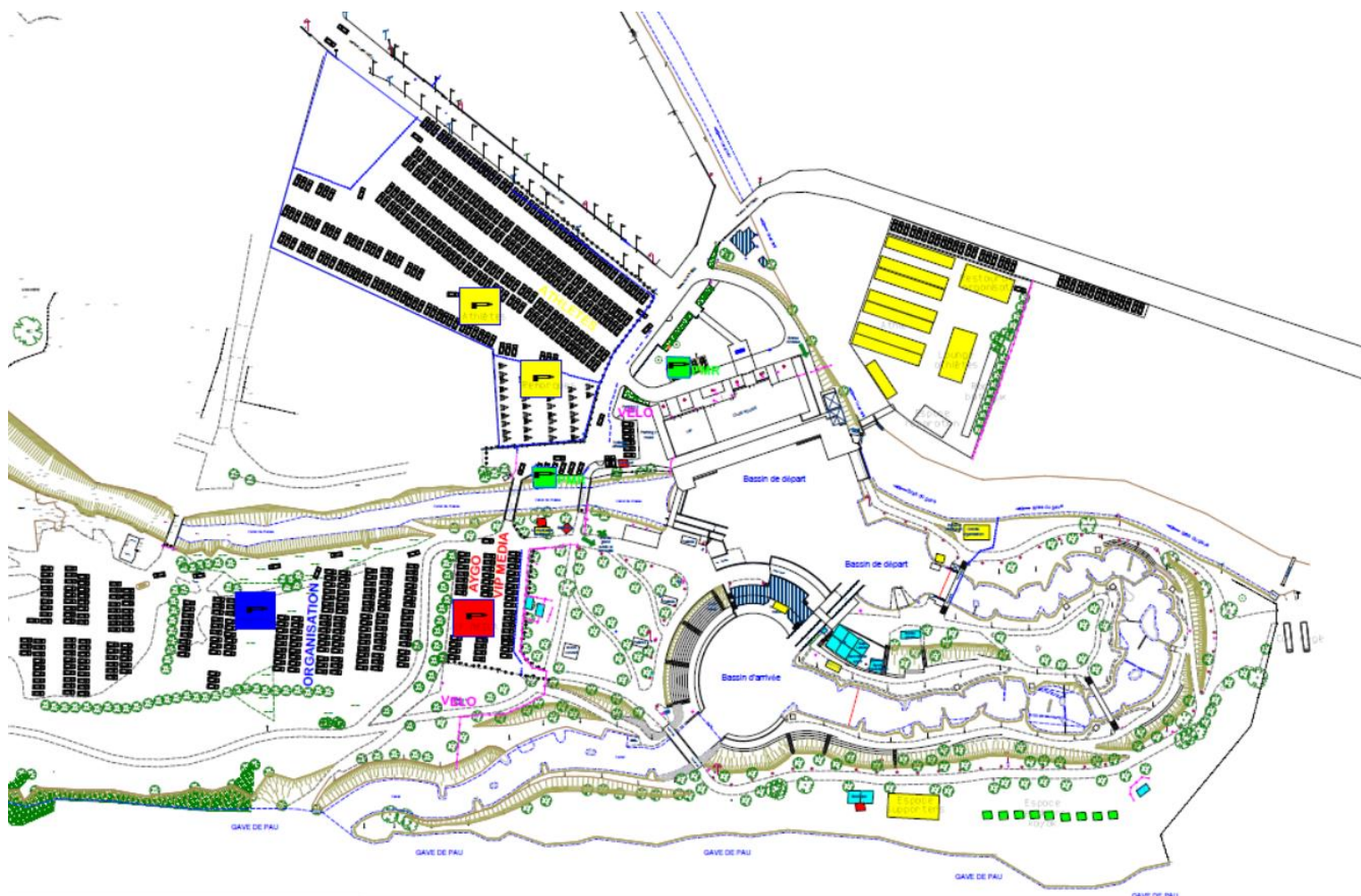

Opening period

The competition venue will be open to all the delegations and secured from the Monday 27th May 2019 at 07.30 to Sunday 2nd June 2019 after the closing ceremony.

Official trainings

Delegations will have access to official trainings from Sunday 26th to Wednesday 29th May as follows

- 1 slot of training per day and per nation
- 25 to 30 boats per group
- Different courses designs will be set-up every day by the Organising Committee
- Water safety will be taken care by the Organising Committee

Competition programme

Day 1 – Thursday 30 th May	Heats Group 1 – C2M, K1W, C1M
Day 2 – Friday 31 st May	Heats Group 2 – C1W, K1M Teams – C2M, C1W, K1M, K1W, C1M
Day 3 – Saturday 1 st June	Semi-finals & Finals Group 1 – C2M, K1W, C1M
Day 4 – Sunday 2 nd June	Semi-finals & Finals Group 2 – C1W, K1M Extreme Slalom

ENTRIES

According to ICF Canoe Slalom rules, each national federation can enter up to 3 boats per event.

Numerical entries : at least 45 days prior the competition according to ICF Canoe Slalom rules.

Nominal entries must be processed via SDP software with is the ICF Entry System Online (www.canoeicf.com).

All nominal entries sent after 20th May 2019 will have to be accepted by the Chairman of ECA Canoe Slalom Committee (Andrej JELENC).

Accreditation types and participation fees

QUALIFICATIONS	REMARKS	COSTS
Athletes	Limited to registered athletes on ICF online entries	110 € per person
Team leaders	2 maximum per national federation	110 € per person
Team staffs	Unlimited	110 € per person
ITO	According to the list edited by ICF	Free
NF President or Secretary General	To be validated by ICF 2 maximum per national federation	Free
NF Guests	Give access to VIP area on Saturday and Sunday	20€ per day per person

How to register ?

You need to enter your teams through the nominal entries via the ICF software SDP in order to validate them. With the nominal entries, all athletes will be automatically pre-accredited, so you do not need to re-enter them. Be careful, you need to enter all your staff members through pre-accreditations !

[Go directly to SDP](#)

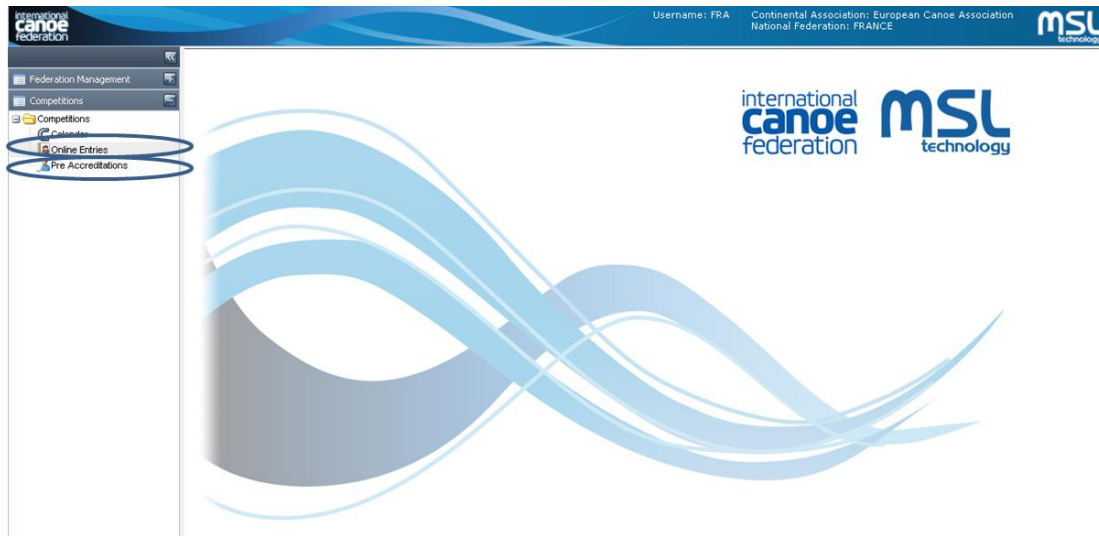

Log with your NF login (provided by ICF) and go to “Online Entries”.

STEP 1 : Online Entries

You just need to complete all your athletes.

STEP 2 : Pre accreditations

You just need to complete all your staff (without athletes).

How to pay ?

The payment of participation fees can be made by bank transfer before you reach Pau or on site upon your arrival by cash or bank card.

Bank details (for bank transfer)

Account owner

Pau Canoë Événements

Stade d’eaux-vives Pau-Pyrénées

35 avenue de l’Yser

64320 BIZANOS

IBAN : FR76 1027 8022 7300 0202 8160 116

BIC : CMCIFR2AXXX

APPENDICES

These registration forms must be received by French Canoe Federation **before 15th April 2019** :
events@ffck.org

PARTICIPATION FORM

Contact details

NATIONAL FEDERATION	
NAME	EMAIL
PHONE	FAX

Delegation composition

Do not forget to enter your numerical entries into SDP software (<https://icf.msl.es/icf/main.jsp>)

QUALIFICATIONS	NUMBER
Athletes	
Team leaders	
Team staffs (coaches, medical people, ...)	
ITO	
NF President or Secretary General	
NF Guests	

TRAVEL DETAILS

Arrival date	
Departure date	
Transportation means <input type="checkbox"/> Plane <input type="checkbox"/> Train <input type="checkbox"/> Car If you travel by plane or train, please indicate below the details about hours and number.	
Arrival place :	From :
Flight/Train number :	
Departure place :	To :
Flight/Train number :	
Do you need a shuttle from and to airport/train station ? <input type="checkbox"/> YES <input type="checkbox"/> NO If from Toulouse/Bordeaux or Biarritz : 15€ per trip per person If from Pau, Tarbes or Lourdes : free trip	

STAMP / Signature	
City	Date

VISA FORM

Civility	Name	First name	Country of birth	Date of birth	Passport number	Expiration date	Status

STAMP / Signature	
City	Date